

- Check for damaged, worn, missing parts and replace if necessary.
- Replace missing or illegible safety decals.

Operating Instructions

- Position the Log Splitter on solid level ground when operating.
- Apply the tractor brake securely and put transmission into Park / Neutral.
- Using left hand lift safety lock. Using right hand to select direction of movement.
- Operate ram to lift wedge above height of log to be split.
- Position centre of log under wedge. Move wedge until contact is made with the log.
- Keep two hands on control levers while splitting log. The speed can be controlled by how much pressure you put on the control valve.
- Stop splitting if log starts to go sideways and reposition per above instructions.
- Should the wedge lodge or become stuck in the log, return wedge to fully open position and gently rock log free before continuing.

Maintenance & Storage

Wipe off your log splitter with a damp cloth periodically to keep it free from debris. The splitting wedge may need sharpening periodically. Just use a file on it as it does not have to have a razor sharp edge. It is recommended that you store your splitter in a dry place when not in use. Ensure that the machine is securely attached to the tractor when transporting. The log splitter is designed only for splitting wood. Using it for any other purpose may damage it.

Limited Warranty

Standard products manufactured by Malone Engineering are warranted to be free from defects in workmanship and material for a period of 120 days from the date of shipment, and products which are defective in workmanship or material will be repaired or replaced, at the option of Malone Engineering, at no charge to the Buyer. Products manufactured by Malone Engineering are designed to perform well under reasonable conditions. Usage of products under extreme conditions and not within recommended guidelines can and will cause excessive wear and damage to the products. Final determination as to whether a product is actually defective rests with Malone Engineering. The obligation of Malone Engineering hereunder shall be limited solely to repair and replacement of products that fall within the foregoing limitations, and shall be conditioned upon receipt by Malone Engineering of notice of any alleged defects or deficiency promptly after discovery within the warranty period.

Technical Specification

Width	91cm	Max Log size	13" x Ø 9"
Height	173cm	Hydraulic connections	2 x ¾" male quick release
Length	74cm	Hydraulic	1 double acting ram
Hoses		Hose size & type	Lgth
Control valve to ram		2X 3/8" 2 wire	26"
		Couplings	Female / 90 deg elbow Female

Control valve to tractor	2X 3/8" 2 wire	4 ft	Male Quick Release / 90 deg elbow female	
Ram	Ø Bore	Ø Rod	Stroke	Power
Wedge Ram	4"	2"	12"	14 tonne

Log Splitter Parts *(Parts and specs. subject to change without notice)*

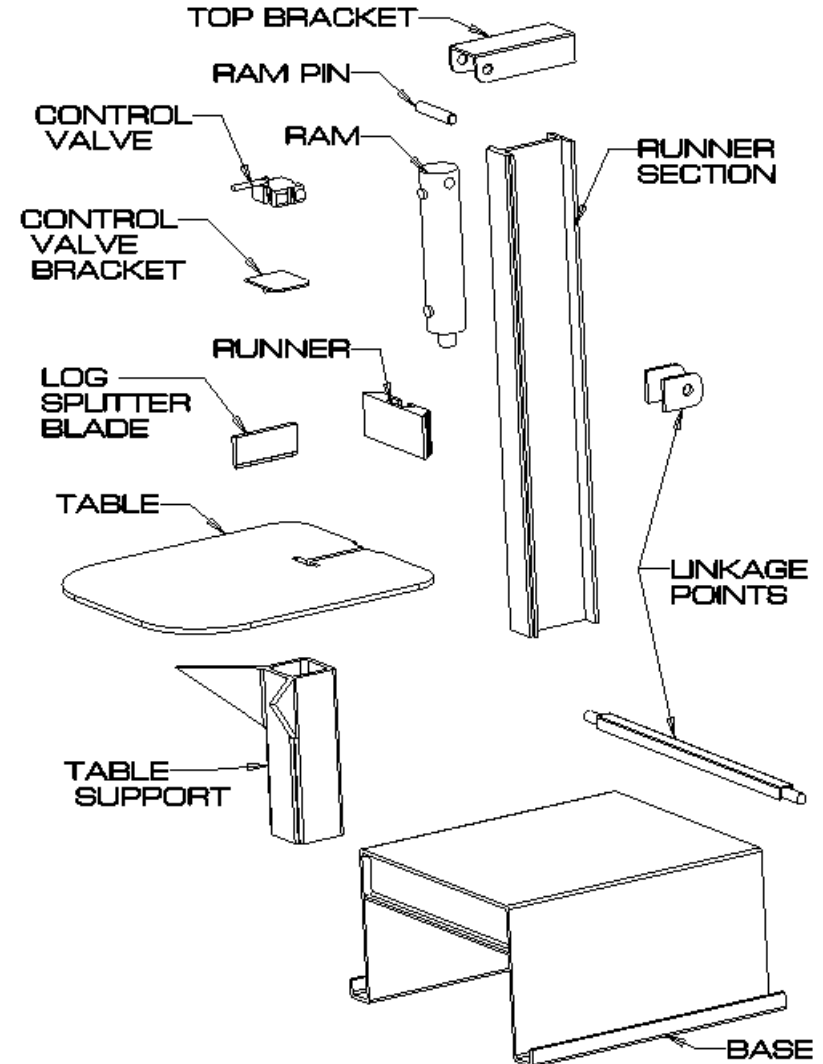



LOG SPLITTER

SAFETY AND USER'S MANUAL



_____ This Data Sheet relates to all Malone Engineering Log Splitters _____

Safety

MALONE ENGINEERING REQUIRES THAT ANYONE OPERATING OR MAINTAINING THE LOG SPLITTER READ AND UNDERSTAND ALL SAFETY, OPERATION AND MAINTENANCE DATA CONTAINED IN THIS USER MANUAL.

The Log Splitter is an attachment for tractors. Hydraulic action provides the force to drive a splitting wedge into a log. Never operate the log splitter if unauthorized persons are in the area, especially small children. Hazards associated with log splitting may be pinch points, splinters, eye injury, and entanglement.

You are responsible for the safe operation and maintenance of the Log Splitter. The most important safety device on the equipment is a safe operator.

Safety Warnings

- Never put hands or fingers between wedge and log to be split or near moving parts.
- The operator should have eye protection and gloves at a minimum.
- Never stand either side of the Log Splitter while operating. Logs can sometimes split apart violently.
- Never hold top of log while setting in place or splitting.
- The Log splitter is very powerful, but some hard or wet wood can be difficult to split. Do not force the wedge as this could cause injury to yourself and damage to the log splitter.
- Never let children operate machinery without adult supervision.
- Both ends of each log should be cut as square as possible to help prevent log from riding out of splitter.
- Never split two logs on top of each other.
- Machine is for single person operation. Operator's two hand are to be on control levers when wedge in motion.
- Operate splitter on solid level ground. Always ensure parking brake is engaged on tractor.

Pre-Operation Checklist

It is important for both personal safety and maintaining the good mechanical condition of the Log Splitter that this checklist is followed.

- Grease slider every 10 hour of operation and pre / post season.
- Check that all hydraulic fittings & connections are tight and in good condition.